

SX41 Series Planar Transformers For 500W – 2KW Applications

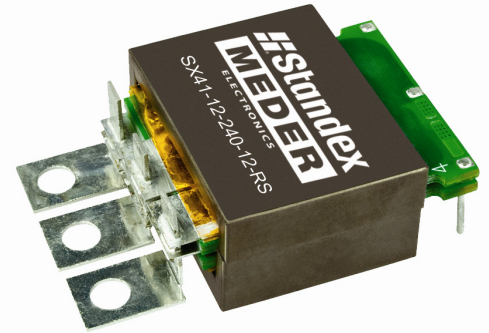

Contact Information:

Standex-Meder Electronics
World Headquarters
4538 Camberwell Road
Cincinnati, OH 45209 USA

Standex Americas (OH)
+1.866.STANDEX
(+1.866.782.6339)
info@standexelectronics.com

Meder Americas (MA)
+1.800.870.5385
salesusa@standexmeder.com

Standex-Meder Asia (Shanghai)
+86.21.37820625
salesasia@standexmeder.com

Standex-Meder Europe (Germany)
+49.7731.8399.0
info@standexmeder.com

- Planar magnetics have a better power density and performance compared to equivalent wire wound transformer designs.
- Standex-Meder has multiple manufacturing facilities around the world including TS16949 and AS9100 certified and ITAR registered sites.
- Applications include Industrial, Welding, Automotive, Telecommunications, Renewable Energy, and Aerospace power conversion where repeatability, efficiency, thermal performance and a low profile are essential.
- Standex-Meder specializes in customizing designs to specific customer needs for a wide power range. Please contact us to provide the optimal solution for your application.

Standard PN Datasheet

Part #	Pri T	Sec T	Output (Typ)	Pri DCR mΩ	Sec DCR mΩ	Vin (min) Freq	Ploss (W)
SX41-05-180-05-RS	24	1T-CT-1T	5V@100A	85	0.90 0.90	180Vdc 100Khz	11.8
SX41-08-180-12-RS	24	2T-CT-2T	12V@67A	85	1.80 1.80	180Vdc 100Khz	11.8
SX41-11-180-24-R	24	2T-T-2T	24V@45A	85	3.2 3.2	180Vdc 100Khz	11.5
SX41-12-180-60-R	24	5T-T-5T	60V@20A	85	7.8 7.8	180Vdc 100Khz	8.6
SX41-12-180-100-R	16	5T-T-5T	100V@12A	39	7.8 7.8	180Vdc 100Khz	4.5
SX41-12-240-12-RS	16	1T-CT-1T	12V@100A	39	0.90 0.90	240Vdc 100Khz	12.4
SX41-12-240-24-RS	16	2T-CT-2T	24V@50A	39	1.80 1.80	240Vdc 100Khz	7.2
SX41-12-240-48-R	16	2T-T-2T	48V@25A	39	3.2 3.2	240Vdc 100Khz	4.6

Notes: All Electrical Values at 25°C | Pri: Sec'y: Core Isolation 3750 VAC / Sec: Core 1500 VDC | Creepage 8mm Pri : Core Maximum Non-Operating Temperatures : -55°C to +130°C | Maximum Operating Rated Temperatures: -30°C to +85°C

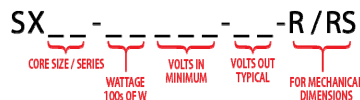

Mechanical Dimensions R Series

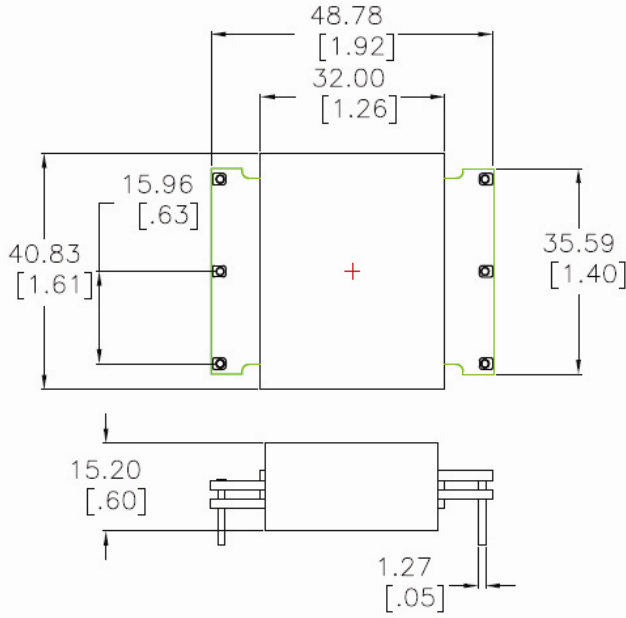

Schematics R Series

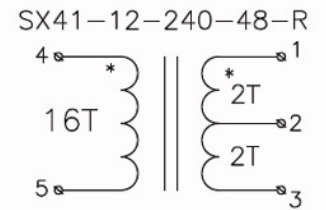
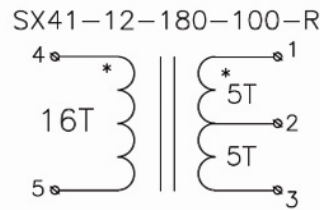
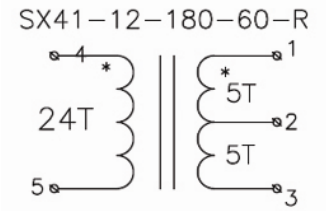
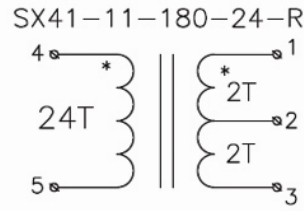

Mechanical Dimensions RS Series

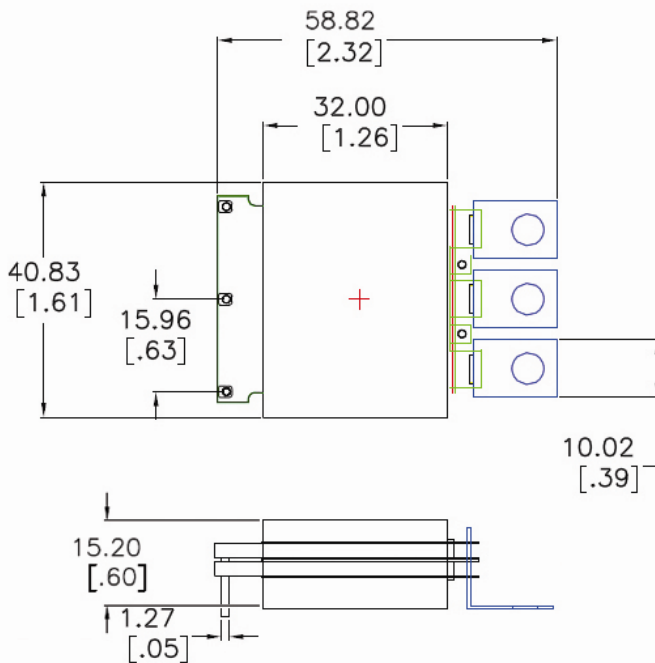

Schematics RS Series

