

Mechanical Dimensions: Inches [mm]

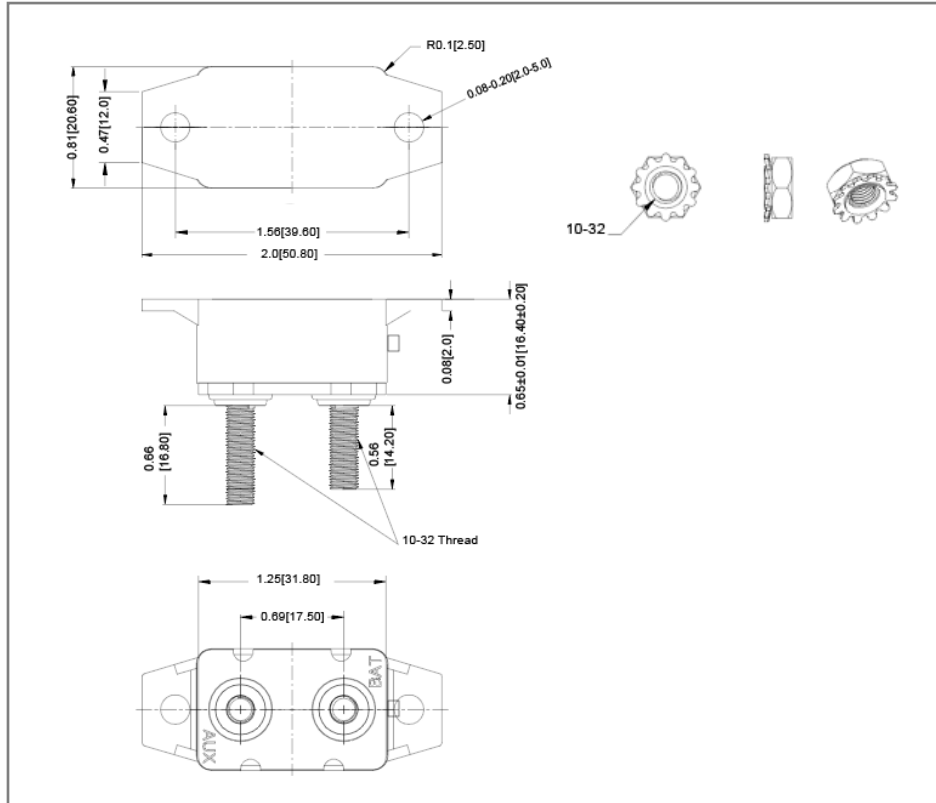

Part Numbers Information

| Optifuse P/N | Current |
|--------------|---------|
| MRCBP-V-6A | 6A |
| MRCBP-V-8A | 8A |
| MRCBP-V-10A | 10A |
| MRCBP-V-15A | 15A |
| MRCBP-V-20A | 20A |
| MRCBP-V-25A | 25A |
| MRCBP-V-30A | 30A |
| MRCBP-V-40A | 40A |
| MRCBP-V-50A | 50A |

Time vs. Percent of Rated Current

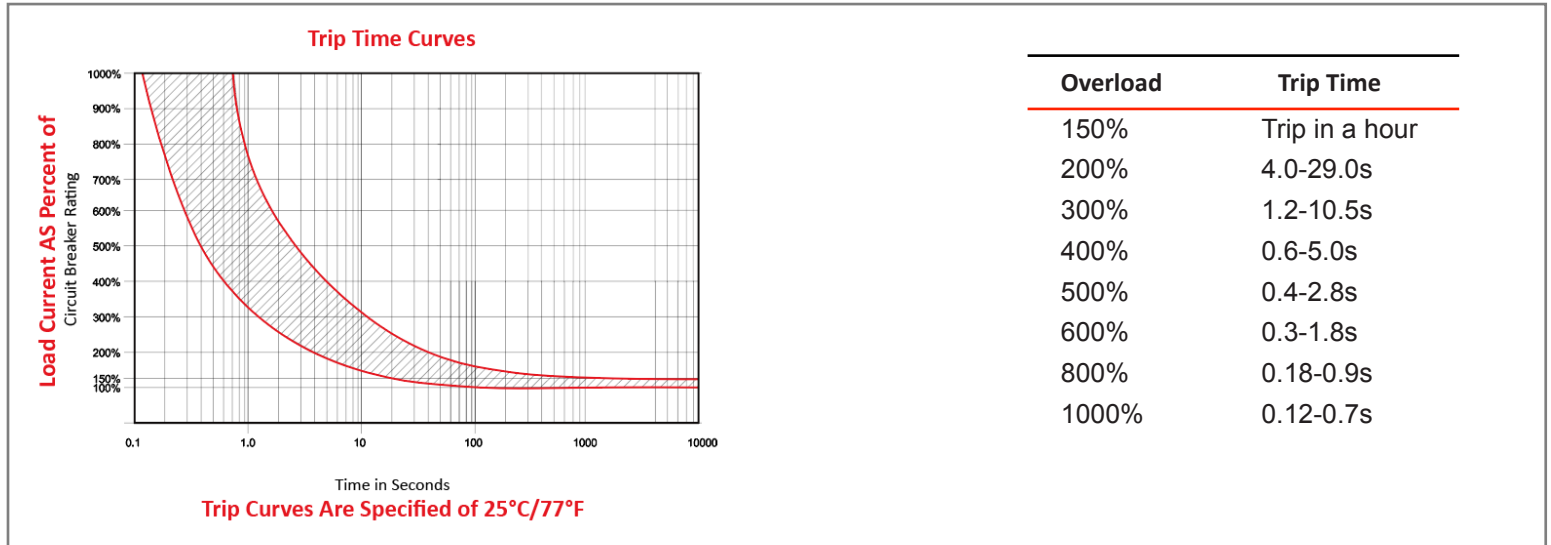

Electrical Specifications

| | |
|-------------------------------|-------------------------|
| Voltage | 32VDC |
| Reset Type | Type III – Manual Reset |
| Limited Short Circuit Current | 1000A (UL1077) |
| Insulation Resistance | DC 500V 100M ohm 5 sec |
| Dielectric Strength | AC 1500V 1 minute |

Material Specifications

| | |
|-----------------------|---|
| Body | Thermoplastic (UL94V-0) |
| Reset button | Thermoset |
| Terminals | Battery – Copper Plate (0.58"), Auxiliary – Zinc Plate (0.66") |
| Mounting Type | Chassis Mount |
| Operation Temperature | -10°C ~ 60°C |

Ambient Temperature Correction Factor

| | |
|--------|-------------------------------|
| -5 °C | (3A-4A)x 1.2, (5A-30A)x 1.12 |
| +40 °C | (3A-4A)x 0.92, (5A-30A)x 0.94 |

The time/current characteristic curve depends on the ambient temperature prevailing. In order to eliminate nuisance tripping. Please multiply the current breaker current ratings by the derating factor shown below.

Example:

| | | |
|---------------------------|------------------|--|
| Normal Continuous Current | 10A | |
| Ambient Temperature | 40 °C | |
| Multiplication Factor | 0.94 | |
| Recommended Rating | $10A/0.94=10.6A$ | |
| Select the Nearest Rating | 11A | |

Rev Date of issue Revision Notes

Designed Approved

| | | | | |
|---|------------|-----------------|----|----|
| B | 04-09-2020 | Initial Drawing | RC | OF |
|---|------------|-----------------|----|----|