

# Type BCM-01

## SMD Fuse Block

### 6.1mm x 2.5mm



www.optifuse.com (619) 593-5050

#### Specifications:

**Fuse Type:** Surface Mount (2410 Package – 6.1mm x 2.5mm)

– For use with OptiFuse FCM / TCM fuses.

**Voltage:** 125V

**Amperage:** 6.3A

**Ambient Temperature:** -55°C to +125°C

#### Material:

**Housing:** Thermoplastic (94V0)

**Terminals:** Beryllium Copper

#### Mechanical Dimensions: Inches [mm]

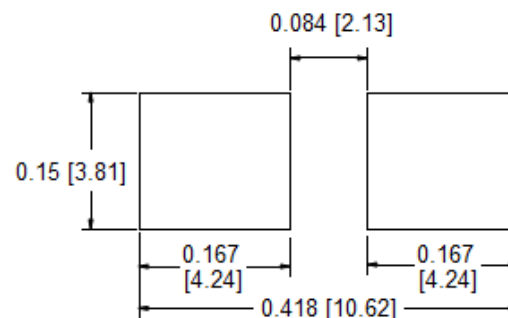
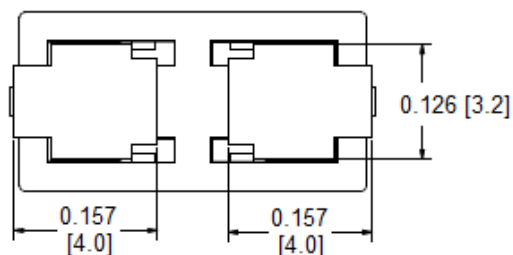
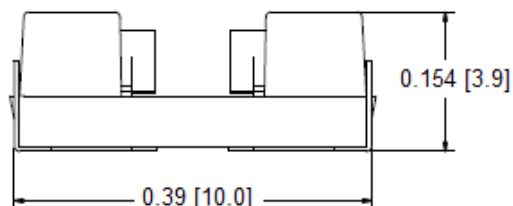
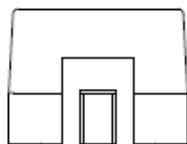
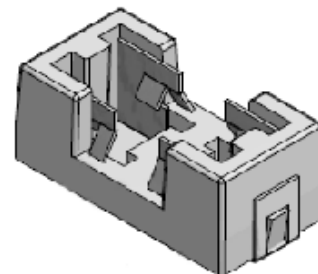
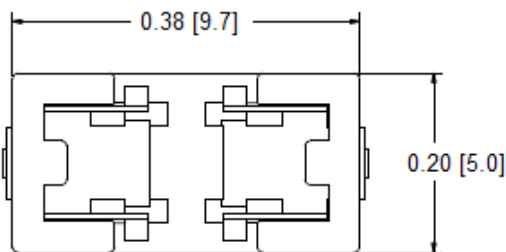

Recommended Pad Layout

#### Warning:



- Operation beyond the specified maximum ratings or improper use may result in damage and possible electrical arcing and/or flame.
- Avoid contact of Fuse device with chemical solvent. Prolonged contact will damage the device performance.