

APPROVED: _____
 DATE: _____ TITLE: _____

Rev	AWO #	Description	Date	Appr
-		UPDATE SPEC.	10/01/16	
A		ADDED LED SCHEMATIC	7/9/19	AY/AY1

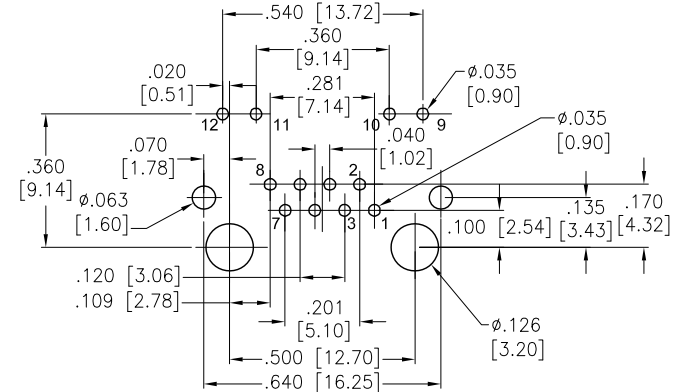

RECOMMENDED PCB LAYOUT

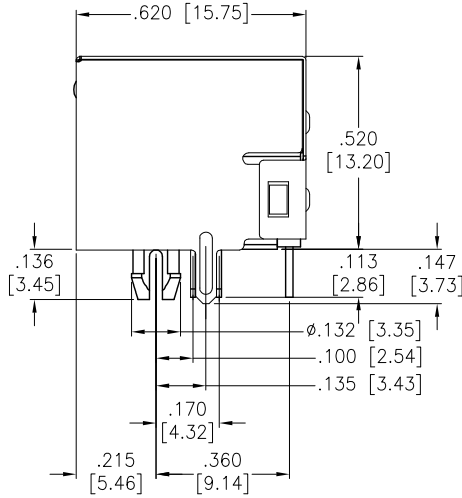
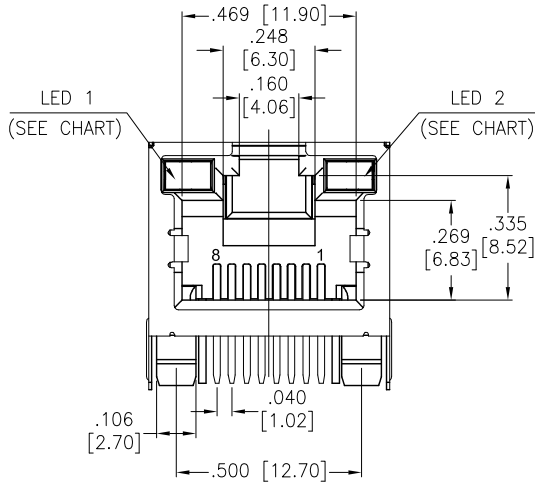
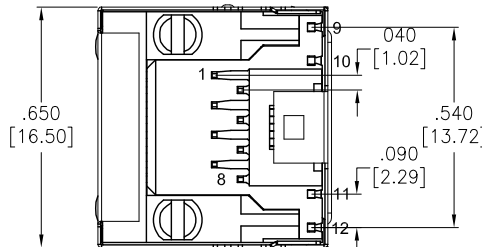

SPECIFICATIONS:

Material:
 Insulator: PBT, glass reinforced, rated UL 94V-0
 Insulator color: Black
 Contacts: Phosphor Bronze
 Shield: Brass, Nickel plated
 Contacts Plating:
 Round contact
 Gold over Nickel underplate overall
 Flat contact
 Gold over Nickel underplate on contact area,
 Tin over Nickel underplate on solder tails

Electrical:
 Voltage rating: 150 VAC rms
 Current rating: 1.5 Amp
 Contact resistance: 20 mohms max.
 Insulation resistance: 1000 Mohms min @ 500 VDC
 Dielectric withstanding voltage:
 Contact to Contact: 1,000 VDC or AC Peak for 1 minute
 Contact to Screen and Test panel: 1,500 VDC or AC Peak for 1 minute

Temperature Rating:
 Operating temperature: -40°C to +85°C
 Environmental:
 Lead free, RoHS compliant.



Part Number	LED 1 Color	LED 2 Color
MTJ-88ARX1-FSM-LD	Green	Green
MTJ-88ARX1-FSM-LG	Yellow	Green
MTJ-88ARX1-FSM-LH	Green	Yellow
MTJ-88ARX1-FSM-LP	Yellow/Green	Yellow/Green
MTJ-88ARX1-FSM-LV	Green	Yellow/Green
MTJ-88ARX1-FSM-L16	Green/Yellow	Green/Yellow

UNLESS OTHERWISE SPECIFIED ALL DIMENSIONS ARE MM [INCHES] TOLERANCES: EXCEPT AS NOTED INCHES HOLES .X ±.10 Ø.X ±.10 .XX ±.020 Ø.XX ±.015 .XXX ±.015 Ø.XXX ±.010		ADAM TECH INTERCONNECTS		909 Rahway Avenue, Union, NJ 07083 Phone: 908-687-5000 Fax: 908-687-5710
		TITLE: MODULAR TELEPHONE JACK, R/A, 8P8C SHIELDED WITH LED'S		
APPROVALS		DATE		
DRAWN	SLS	10/01/16		
CHECKED		SIZE	PART NO.	REV.
APPROVED		X	MTJ-88ARX1-FSM-LX	A
REF: S00005C		SCALE: NTS	SHEET 1 OF 2	

6

5

4

3

2

1

APPROVED: _____

DATE: _____ TITLE: _____

Rev	AWO #	Description	Date	Appr
		SEE SHT 1 OF 2 FOR REVISION		

LED SCHEMATIC

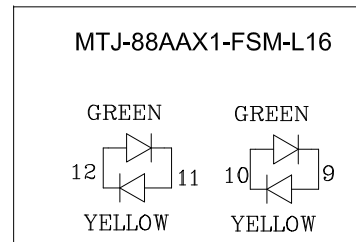
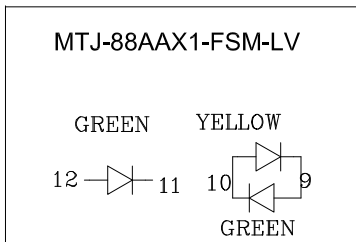
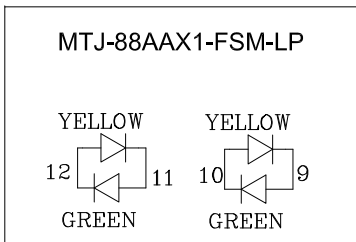
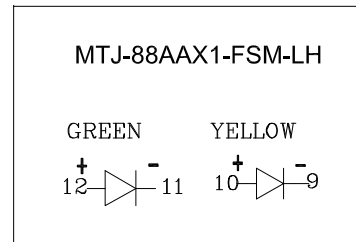
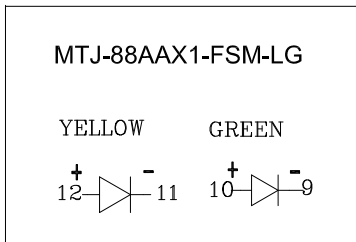
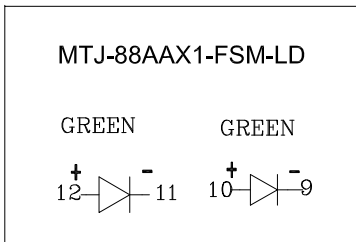

UNLESS OTHERWISE SPECIFIED
ALL DIMENSIONS ARE MM [INCHES]
TOLERANCES: EXCEPT AS NOTED
INCHES HOLES

.X	± .10	∅X	±.10
.XX	± .020	∅.XX	±.015
.XXX	± .015	∅.XXX	±.010

APPROVALS		DATE
DRAWN	SLS	10/01/16
CHECKED		
APPROVED		

ADAM TECH INTERCONNECTS 909 Rahway Avenue,
Union, NJ 07083
Phone: 908-687-5000
Fax: 908-687-5710

TITLE MODULAR TELEPHONE JACK, R/A, 8P8C SHIELDED WITH LED'S		
SIZE X	PART NO. MTJ-88ARX1-FSM-LX	REV. A
REF: S00005C	SCALE: NTS	SHEET 2 OF 2

6

5

4

3

2

1