

6

5

4

3

2

1

APPROVED: \_\_\_\_\_  
 DATE: \_\_\_\_\_ TITLE: \_\_\_\_\_

Rev	AWO #	Description	Date	Appr
-		RELEASED	8/16/21	

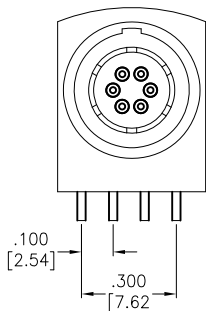
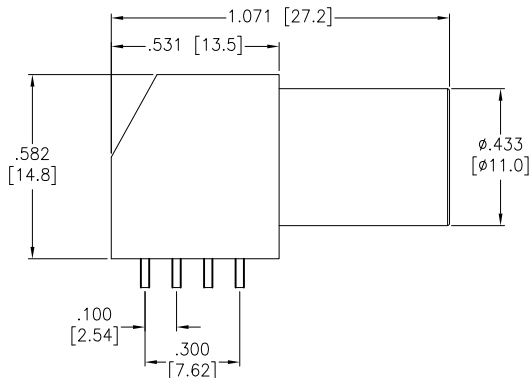

MMI-ES1GXXPR

# OF POSITIONS  
 (02, 03, 04, 05, 06, 07, 08 & 10)

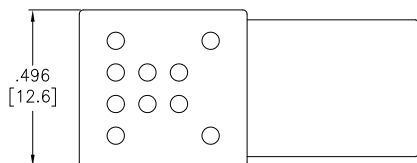
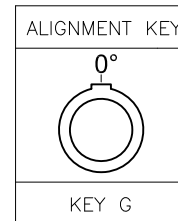

	2 Pin	3 Pin	4 Pin	5 Pin	6 Pin	7 Pin	8 Pin	10 Pin
Configuration								
Testing Voltage	1700V	1700V	1600V	1300V	1350V	1450V	1300V	1000V
Working Voltage	300V	300V	250V	250V	200V	200V	200V	200V
Rated Current / Pin	4.5A	4.5A	4.5A	4.5A	4.5A	2A	2A	1.5A

**SPECIFICATIONS:**

Material:  
 Insulator: (PPS) Hi-temp thermoplastic, rated UL 94V-0  
 Insulator color: Black  
 Contacts: Brass, Gold plated  
 Shell: Brass  
 Electrical:  
 Voltage Rating: 250V  
 Current Rating: See chart  
 Dielectric withstanding voltage: See chart  
 Electrical Life: 1,000 Cycles min.  
 Mechanical:  
 Endurance: 5,000 Cycles Min.  
 Temperature Rating:  
 Operating temperature: -55°C to +150°C  
 Environmental:  
 IP50 Protection (Mated Condition)  
 Lead free, RoHS compliant



UNLESS OTHERWISE SPECIFIED  
 ALL DIMENSIONS ARE INCHES [MM]  
 TOLERANCES: EXCEPT AS NOTED

INCHES		HOLES	
.X	± .10	Ø.X	± .10
.XX	± .020	Ø.XX	± .015
.XXX	± .015	Ø.XXX	± .010



909 Rahway Avenue,  
 Union, NJ 07083  
 Phone: 908-687-5000  
 Fax: 908-687-5710

APPROVALS		DATE
DRAWN	SS	8/16/21
CHECKED	SS	8/16/21
APPROVED		

TITLE PUSH-PULL ELBOW SOCKET, RIGHT ANGLE, SIZE 1, PCB MOUNT, IP50		
SIZE X	PART NO. MMI-ES1GXXPR	REV. -
REF: SXXXXXX	SCALE: NTS	SHEET 1 OF 2

6

5

4

3

2

1

6

5

4

3

2

1

APPROVED: \_\_\_\_\_

DATE: \_\_\_\_\_ TITLE: \_\_\_\_\_

Rev	AWO #	Description	Date	Appr
-		RELEASED	8/16/21	

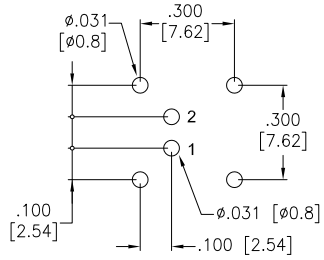

2 PIN

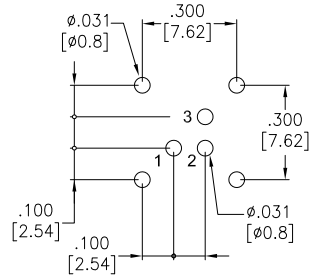

3 PIN

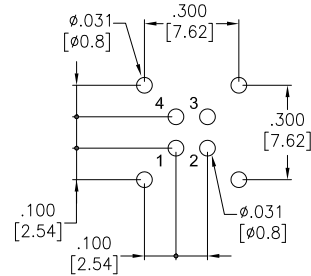

4 PIN

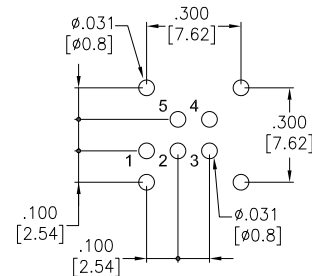

5 PIN

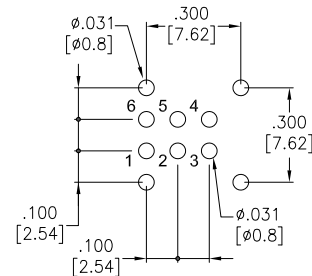

6 PIN

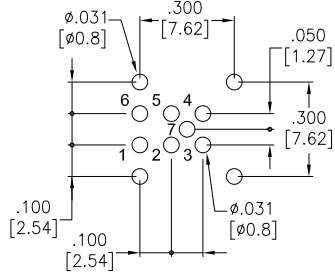

7 PIN

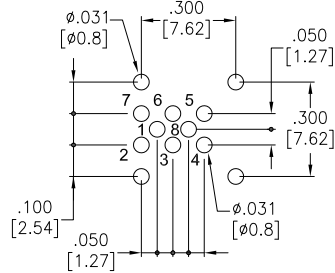

8 PIN

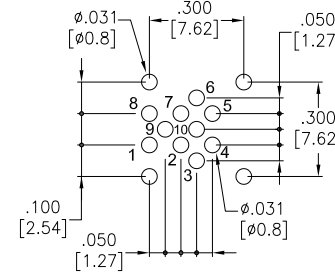

10 PIN

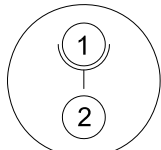

2 PIN

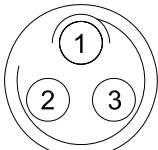

3 PIN

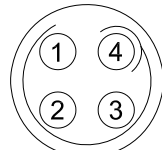

4 PIN

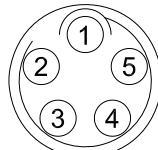

5 PIN

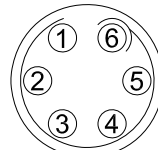

6 PIN

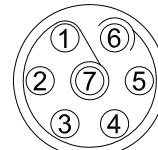

7 PIN

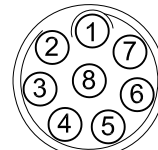

8 PIN

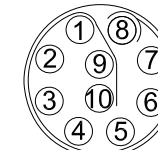

10 PIN

UNLESS OTHERWISE SPECIFIED  
 ALL DIMENSIONS ARE INCHES [MM]  
 TOLERANCES: EXCEPT AS NOTED  
 INCHES HOLES

.X	± .10	∅X	± .10
.XX	± .020	∅.XX	± .015
.XXX	± .015	∅.XXX	± .010



909 Rahway Avenue,  
 Union, NJ 07083  
 Phone: 908-687-5000  
 Fax: 908-687-5710

APPROVALS		DATE
DRAWN	SS	8/16/21
CHECKED	SS	8/16/21
APPROVED		

TITLE PUSH-PULL ELBOW SOCKET, RIGHT ANGLE, SIZE 1, PCB MOUNT, IP50		
SIZE X	PART NO. MMI-ES1GXXPR	REV. -
REF: SXXXXX	SCALE: NTS	SHEET 2 OF 2

6

5

4

3

2

1