

| Rev | AWO # | Description | Date | Appr |
|-----|-------|-------------|----------|------|
| - | | RELEASED | 11/15/04 | |

APPROVED: _____
 DATE: _____ TITLE: _____

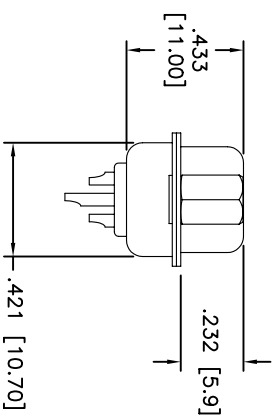
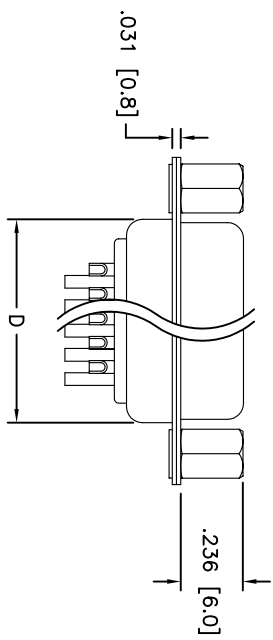
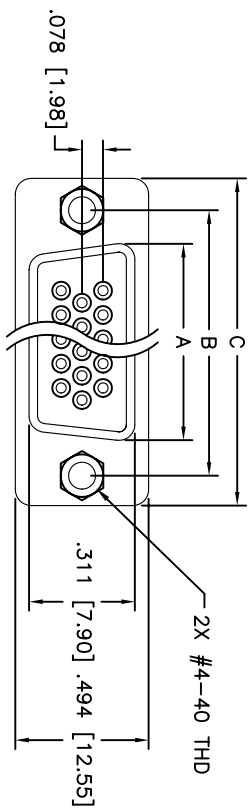

Unit: Inch / mm

| POSITIONS | Socket Dimensions | | | |
|-----------|-------------------|---------------|---------------|---------------|
| | A | B | C | D |
| 15 | .643 (16.33) | .984 (24.99) | 1.213 (30.81) | .759 (19.28) |
| 26 | .971 (24.66) | 1.312 (33.32) | 1.541 (39.14) | 1.083 (27.51) |
| 44 | 1.511 (38.38) | 1.852 (47.04) | 2.008 (53.04) | 1.626 (41.30) |
| 62 | 2.159 (54.84) | 2.500 (63.50) | 2.729 (69.32) | 2.272 (57.71) |

SPECIFICATIONS:
 Material: Insulator: PBT, glass reinforced, rated UL 94V-0
 Insulator color: Black
 Contacts: Phosphor Bronze
 Plating: Gold Flash over Nickel underplate overall
 Electrical: Operating voltage: 250 VAC max
 Current rating: 5 Amps max
 Insulation resistance: 5000 Mohms min @ 500 VDC
 Dielectric withstanding voltage: 1000 VAC for 1 minute
 Temperature Rating: Operating temperature: -65°C to +125°C

ADAM TECH

909 Rahway Avenue, Union, NJ 07083
 Phone: 908-687-5000 Fax: 908-687-5710

D-SUB, HIGH DENSITY, STRAIGHT FEMALE SOLDER CUP

| | | | |
|--|--------|-----------|--------------|
| UNLESS OTHERWISE SPECIFIED ALL DIMENSIONS ARE INCHES [MM] TOLERANCES: EXCEPT AS NOTED INCHES | | HOLE SIZE | |
| .X | ± .10 | ØX | ± .10 |
| .XX | ± .020 | ØXXX | ± .015 |
| .XXX | ± .015 | ØXXXX | ± .010 |
| APPROVALS | | DATE | |
| DRAWN | SS | 11/15/04 | |
| CHECKED | | | |
| APPROVED | | | |
| TITLE | | SIZE | PART NO. |
| D-SUB, HIGH DENSITY, STRAIGHT FEMALE SOLDER CUP | | X | HDTXX-SD-JS |
| REF: | | SCALE: | SHEET 1 OF 1 |

6 5 4 3 2 1