

Illustrations

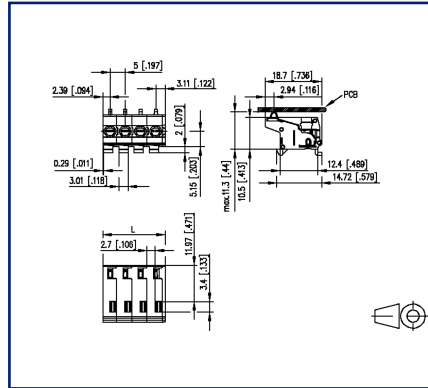

Dimensional drawing



Drill pattern

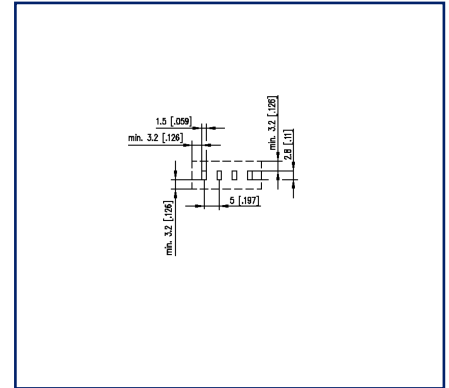

See enlarged drawings at the end of document

Product specification

- spring clamp terminal block, pluggable
- centerline 5.00 mm, direction of connection 90°
- fittable without loss of poles
- color black

## Technical Data



### General Data

min. number of poles	2		
max. number of poles	12		
Insulating material class	CTI 600		
clearance/creepage dist.	3.2 mm		
Protection category	IP00		
Min. insul. strip length	7.5 mm		
Rated current	4 A		
Overvoltage category	III	III	II
Pollution degree	3	2	2
Rated voltage	250 V	630 V	630 V
Rated test voltage	4 kV	4 kV	4 kV

### Terminal data

rat.wiring solid AWGmax	0.08 mm <sup>2</sup> - 1.5 mm <sup>2</sup> / AWG 28 - AWG 16		
rat.wiring strand.AWGmax	0.08 mm <sup>2</sup> - 1.5 mm <sup>2</sup> / AWG 28 - AWG 16		

### Approvals

 V / A / AWG	300 / 4 / 28 - 16		
approval UL - File No.	E121004		
 1.5 mm <sup>2</sup>	T60 / 250 V / 4 A / 3 /		

### Material

insulating material	PPA
flammability class	V0
spring material	Spring steel
contact material	CuSn
Contact surface	Sn
Glow-Wire Flammability GWFI	960 °C acc. to IEC 60695-2-12
Glow-Wire Flammability GWIT	800 °C acc. to IEC 60695-2-13
REACH	compliant

### Climatic Data

upper limit temperature	105 °C
lower limit temperature	-40 °C

### general

Tolerance	ISO 2768 -mH
-----------	--------------

### Sicherheitshinweis

# U | Contact

Data sheet  
**SC305xxHBNN**

Page 3/5

**P/N**  
**SC305XXHBNN**  
**xx=number of poles**  
2022/04/05  
Version: AK

## Technical Data

Safety instructions

1. Disconnect device from mains before opening, because of exposed contacts  
2. Housing cutout to lock the terminal block must be insulating



**Illustrations**

Dimensional drawing

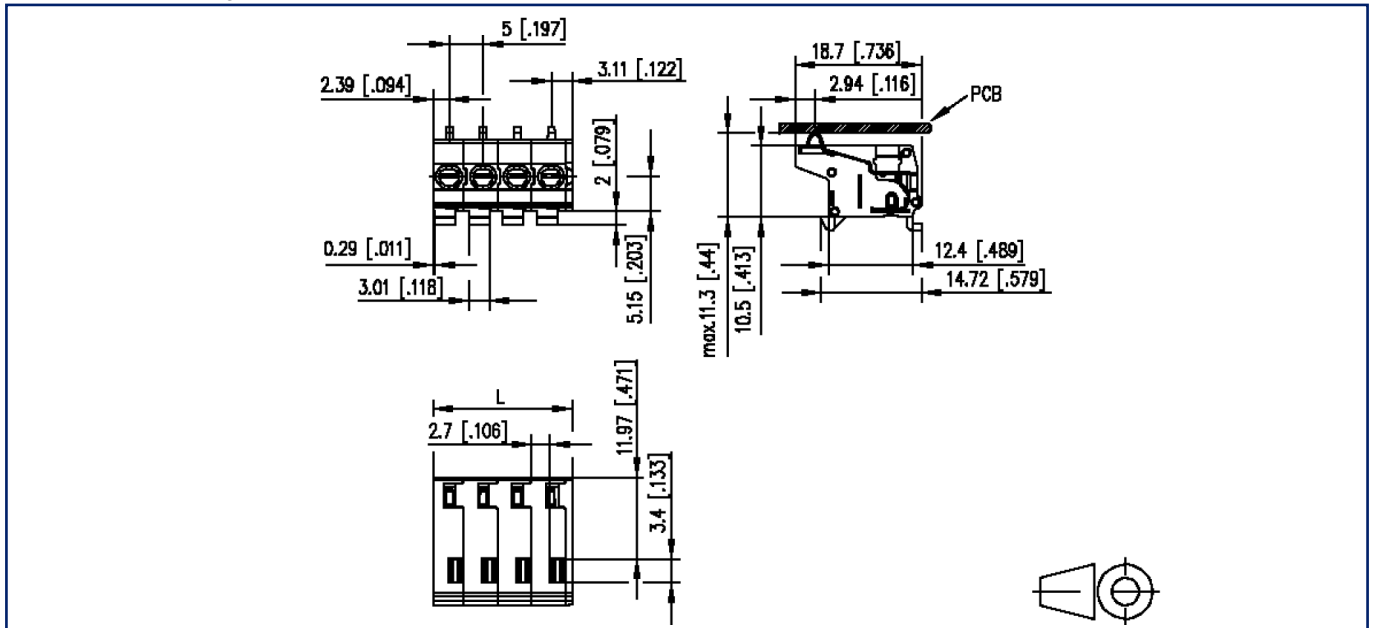

$L = (\text{pole size} - 1) \times \text{centerline} + 5.5 \text{ mm} [0.217]$

**Illustrations**

Drill pattern

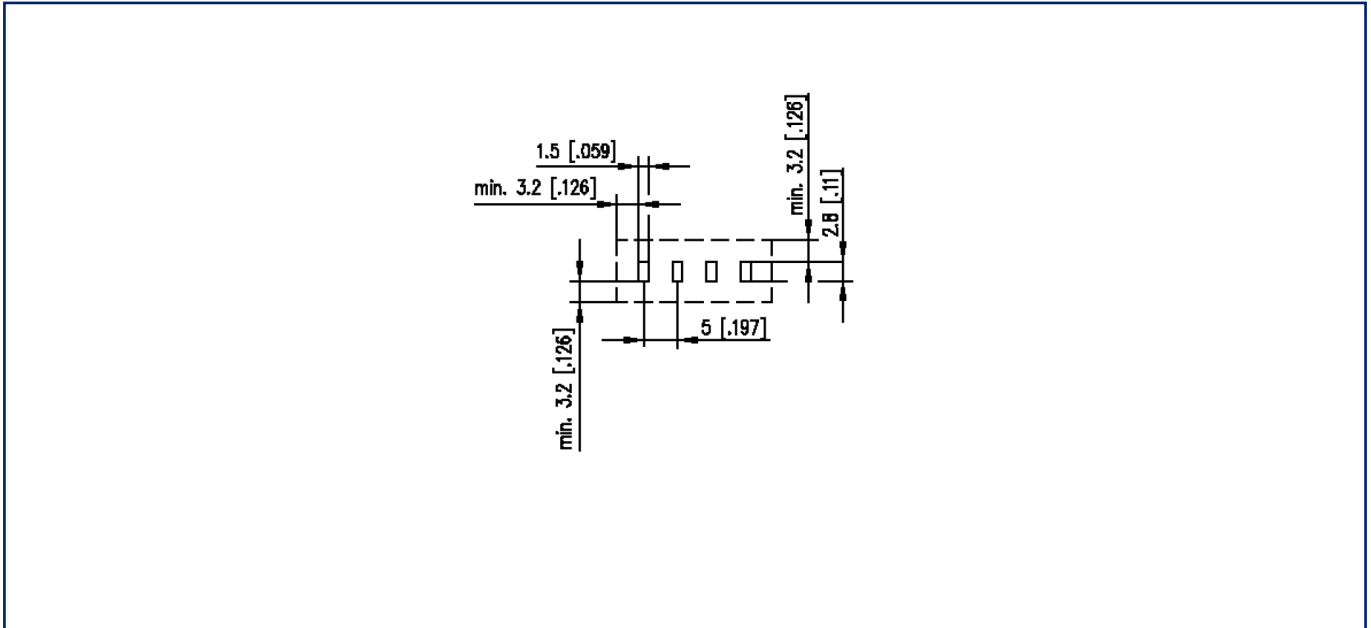

Application example

