

Data sheet

RP023xxHBNF Typ 165

Illustrations



Dimensional drawing

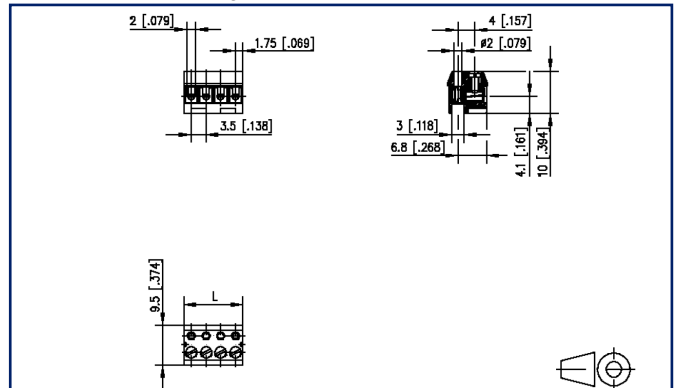

See enlarged drawings at the end of document

Product specification

- screw type terminal block, pluggable
- centerline 3.50 mm, direction of connection 90°
- wire protector, fittable without loss of poles
- color black

Technical Data



General Data

Tightening torque SEV	0.15 Nm		
Tightening torque UL	1.3 lb-in		
min. number of poles	2		
max. number of poles	24		
Insulating material class	CTI 600		
clearance/creepage dist.	2 mm		
Protection category	IP00		
Min. insul. strip length	5 mm		
Rated current	6 A		
Overvoltage category	III	III	II
Pollution degree	3	2	2
Rated voltage	32 V	250 V	250 V
Rated test voltage	1.5 kV	1.5 kV	1.5 kV

Terminal data

rat.wiring solid AWGmax	0.08 mm ² - 1.5 mm ² / AWG 28 - AWG 16		
rat.wiring strand.AWGmax	0.08 mm ² - 1.5 mm ² / AWG 28 - AWG 16		

Approvals

 V / A / AWG	125 / 10 / 28 - 16		
approval UL - File No.	E121004		
 1 mm ²	200 V / 2.5 kV / 6 A		

Material

insulating material	PA66
flammability class	V0
contact material	CuNiZn
terminal body thread	M2
terminal body material	CuZnPb
terminal body surface	Ni
screw thread	M2
screw material	8,8
screw surface	Zn Cr(VI)-frei/free
wire protector material	CuNiZn
Glow-Wire Flammability GWFI	960 °C acc. to IEC 60695-2-12

U | Contact

Data sheet RP023xxHBNF Typ 165

Page 3/6

P/N
311651xx

xx=number of poles

2022/04/05

Version: T

Technical Data

Glow-Wire Flammability GWIT	775 °C acc. to IEC 60695-2-13
REACH	compliant
REACH - substance (SVHC)	Lead / 7439-92-1

Climatic Data

upper limit temperature	105 °C
lower limit temperature	-40 °C

general

Tolerance	ISO 2768 -mH
-----------	--------------

Accessories

P/N	Designation
720158-01-0	Befestigungsflansch kurz LP1mmfür Typ 165, 166 F_Befest_165_brg_kurz 1mm
720158-01-2	720158
720158-02-2	Mounting flange for type 166
720159-01-0	Kodierstift kurz für Typ 165, 166 F_Kodier_Typ165_brg_kurz
720159-01-2	Coding pin short for type 166
720159-02-0	Kodierstift lang für Typ 165, 166 F_Kodier_Typ165_brg_lang
720159-02-2	Coding pin long for type 166

U | Contact

Data sheet
RP023xxHBNF Typ 165

Page 5/6

P/N
311651xx
xx=number of poles
2022/04/05
Version: T

Counterpart

P/N	Designation
310241	PR013xxVBHC Typ 024

© 2022 METZ CONNECT - Technische Änderungen vorbehalten! Subject to modifications! Sous réserve de modifications techniques!

Illustrations

Dimensional drawing

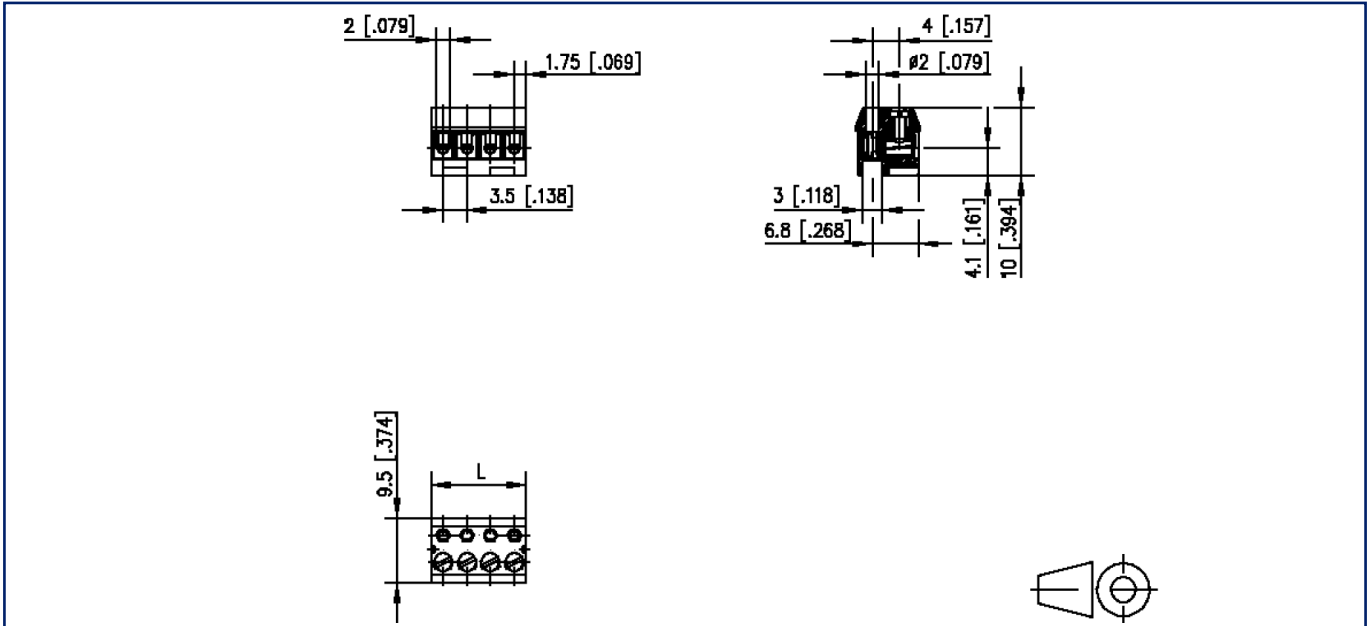

$L = (\text{pole size} - 1) \times \text{centerline} + 3.5 \text{ mm } [0.138]$