

Headers

to **Type 007** and **Type 077**

- Type 017** page 124
- Type 027** page 124
- Type 039** page 133
- Type 041** page 127
- Type 417** page 126

Accessories

- for **Type 007**
- Coding pin**
- 710121 short
- 720122 long page 176
- Coding set**
- 716846 page 177
- Latching flange**
- 710084 right
- 710085 left page 173
- for **Type 077**
- Coding pin**
- 710121 short
- 710122 long page 176
- Coding set**
- 716846 page 177
- Mounting flange**
- 750150 right
- 750151 left page 174

Note for wire range

Additional wire sizes and/or combinations of same size wires as follows:

Type 07 and Type 77

- #(1) Wire range extended to No. 30 AWG for factory-wiring.
- + Two same size wires No. 22 - 16 AWG Cu Sol/Str for field-wiring; No. 30 - 16 AWG Cu Sol/Str factory-wiring.

Type 007

Screw type terminal block, pluggable, centerline 5 mm / 0.197 inches, wire entry perpendicular to plug direction, wire protector, female contact

Technical Data

	V / A / AWG	300 / 15 / 22 - 12
	0.33 - 2.5 mm ²	125 V / 2.5 kV / 10 A
Insulation co-ordination according to IEC 664-1		
Clearance and creepage distances	min. 2.3 mm	
Insulating material class	CTI 600	
Overvoltage category	III	III II
Pollution degree	3	2 2
Rated voltage	160	400 400
Rated test voltage	2.5	4 2.5
Protection category according to IEC 529	IP20	
Tightening torque UL	7 lb-in max.	
Min. insul. strip length	6 mm	
Pole size	2 - 24	
Color	black	

Dimensions in mm 1 mm = 0.0394 in.

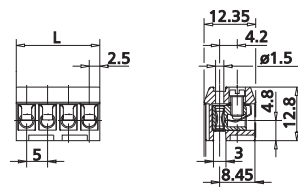

$L = (\text{pole size} - 1) \times \text{centerline} + 5 \text{ mm} / 0.197 \text{ inches}$

Type 077

Screw type terminal block, pluggable, centerline 5 mm / 0.197 inches, wire entry perpendicular to plug direction, wire protector, modular, female contact

Technical Data

	V / A / AWG	300 / 15 / 22 - 14
	0.33 - 2.5 mm ²	125 V / 2.5 kV / 10 A
Insulation co-ordination according to IEC 664-1		
Clearance and creepage distances	min. 2.3 mm	
Insulating material class	CTI 600	
Overvoltage category	III	III II
Pollution degree	3	2 2
Rated voltage	160	400 400
Rated test voltage	2.5	4 2.5
Protection category according to IEC 529	IP00	
Tightening torque UL	7 lb-in max.	
Min. insul. strip length	6 mm	
Pole size	2 - 3	
Color	black	

Dimensions in mm 1 mm = 0.0394 in.

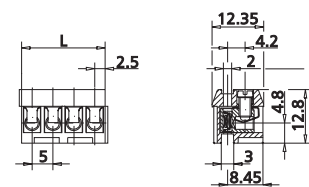

$L = (\text{pole size} - 1) \times \text{centerline} + 5 \text{ mm} / 0.197 \text{ inches}$

Part numbers (P/N)

(informations: page 60)

Complete the part number by adding the pole size.

Type 007

centerline 5 mm / 0.197 inches

P/N 310071

	02	03	04	05	06	07	08
	09	10	11	12	13	14	15
	17	18	19	20	21	22	23
	24						

Type 007

centerline 10 mm / 0.394 inches

P/N 310072

	02	03	04	05	06	07	08
	09	10	11	12			

Standard pole sizes

Available on demand. Minimum order quantity 5000 pieces per item.

Part numbers (P/N)

(informations: page 60)

Complete the part number by adding the pole size.

Type 077

centerline 5 mm / 0.197 inches

P/N 310771

	02	03				

Standard pole sizes

Available on demand. Minimum order quantity 5000 pieces per item.

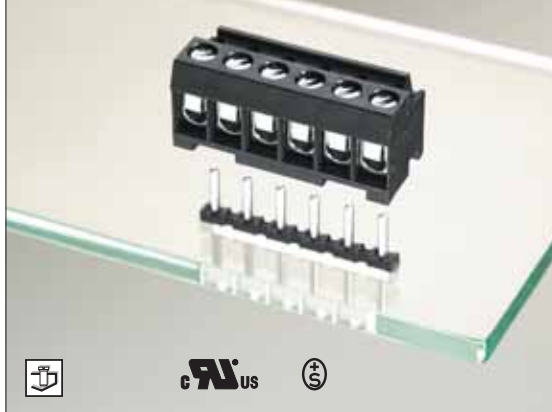

Headers

to **Type 107**

- Type 017** page 124
- Type 027** page 124
- Type 039** page 133
- Type 041** page 127
- Type 417** page 126

Accessories

for **Type 107** and **Type 108**
Coding pin

- 710121 short
- 720122 long page 176
- Coding set**
- 716846 page 177
- Latching flange**
- 710084 right
- 710085 left page 173

Type 107

Screw type terminal block, pluggable, centerline 5 mm / 0.197 inches, wire entry perpendicular to plug direction, contact system with integrated wire protection

Technical Data

V / A / AWG 300 / 10 / 28 - 12

0.08 - 1.5 mm² 125 V / 2.5 kV / 6 A

Insulation co-ordination according to IEC 664-1

Clearance and creepage distances min. 2.3 mm

Insulating material class CTI 600

Overvoltage category III III II

Pollution degree 3 2 2

Rated voltage 160 400 400

Rated test voltage 2.5 4 2.5

Protection category according to IEC 529

IP00

Tightening torque UL 6 lb-in max.

Min. insul. strip length 6 mm

Pole size 2 - 24

Color black

Dimensions in mm 1 mm = 0.0394 in.

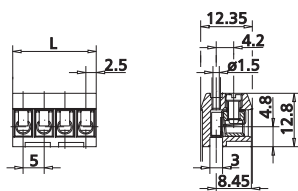

$L = (\text{pole size} - 1) \times \text{centerline} + 5 \text{ mm} / 0.197 \text{ inches}$

Type 108

Screw type terminal block, pluggable, centerline 5 mm / 0.197 inches, wire entry perpendicular to plug direction, contact system with integrated wire protection, factory inserted pins

Technical Data

V / A / AWG 300 / 10 / 28 - 12

0.08 - 1.5 mm² 125 V / 2.5 kV / 6 A

Insulation co-ordination according to IEC 664-1

Clearance and creepage distances min. 2.3 mm

Insulating material class CTI 600

Overvoltage category III III II

Pollution degree 3 2 2

Rated voltage 160 400 400

Rated test voltage 2.5 4 2.5

Protection category according to IEC 529

IP00

Tightening torque UL 6 lb-in max.

Min. insul. strip length 6 mm

Solder pin dimension 1.0 x 1.0 mm

Recommended pc board hole dia. Ø 1.5 mm

Solder pin length 4.3 mm

Pole size 2 - 24

Color black

Dimensions in mm 1 mm = 0.0394 in.

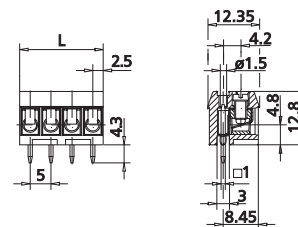

$L = (\text{pole size} - 1) \times \text{centerline} + 5 \text{ mm} / 0.197 \text{ inches}$

Part numbers (P/N)

(informations: page 60)

Type 107

centerline 5 mm / 0.197 inches

P/N 311071

Complete the part number by adding the pole size.

	02	03	04	05	06	07	08
09	10	11	12	13	14	15	16
17	18	19	20	21	22	23	24

Standard pole sizes

Available on demand. Minimum order quantity 5000 pieces per item.

Part numbers (P/N)

(informations: page 60)

Type 108

centerline 5 mm / 0.197 inches

P/N 311081

Complete the part number by adding the pole size.

	02	03	04	05	06	07	08
09	10	11	12	13	14	15	16
17	18	19	20	21	22	23	24

Standard pole sizes

Available on demand. Minimum order quantity 5000 pieces per item.

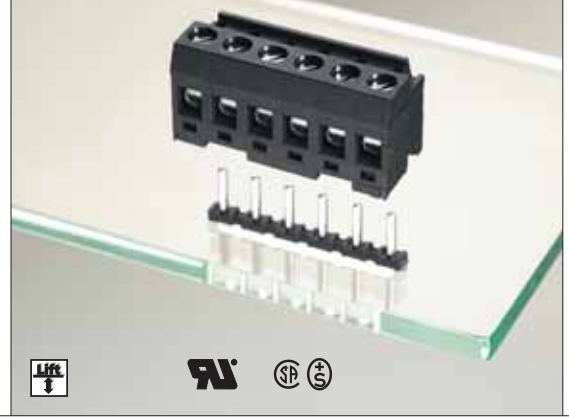

Headers

- to Type 157
 - Type 046 page 125
 - Type 318 page 126

- to Type 137
 - Type 027 page 124

Accessories

- for Type 137
 - Coding pin 720161 short page 177
 - Coding pin 720161 long page 177
 - Coding set 716846 page 177
 - Mounting flange 750313 right page 174
 - Mounting flange 750314 left page 174

Installation conditions for type 157

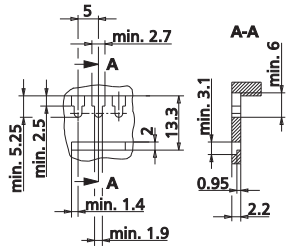

Type 157

Screw type terminal block, pluggable, centerline 5 mm / 0.197 inches, wire entry perpendicular to plug direction, contact system with integrated wire protection, top side pin insertion, clip system for mounting into a housing

Technical Data

Ⓢ	0.08 - 1.5 mm ²	320 V / 4 kV / 10 A
Insulation co-ordination according to IEC 664-1		
Clearance and creepage distances	min. 4.15 mm	
Insulating material class	CTI 600	
Overvoltage category	III	III II
Pollution degree	3	2 2
Rated voltage	320	800 800
Rated test voltage	4	6 4
Protection category according to IEC 529	IP20	
Tightening torque UL	4.4 lb-in max.	
Min. insul. strip length	6 mm	
Pole size	2 - 24	
Color	black	

Type 137

Screw type terminal block, pluggable, centerline 5 mm / 0.197 inches, wire entry perpendicular to plug direction, lift system, female contact

Technical Data

V / A / AWG	300 / 15 / 26 - 12
Ⓢ V / A / AWG	300 / 15 / 26 - 12
Ⓢ	0.12 - 1.5 mm ² 250 V / 4 kV / 10 A
Insulation co-ordination according to IEC 664-1	
Clearance and creepage distances	min. 3.2 mm
Insulating material class	CTI 600
Overvoltage category	III III II
Pollution degree	3 2 2
Rated voltage	250 630 630
Rated test voltage	2.5 6 4
Protection category according to IEC 529	IP20
Tightening torque UL	4.5 lb-in max.
Min. insul. strip length	8 mm
Pole size	2 - 24
Color	black

Dimensions in mm 1 mm = 0.0394 in.

Dimensions in mm 1 mm = 0.0394 in.

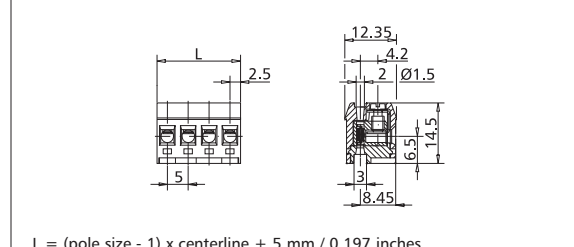
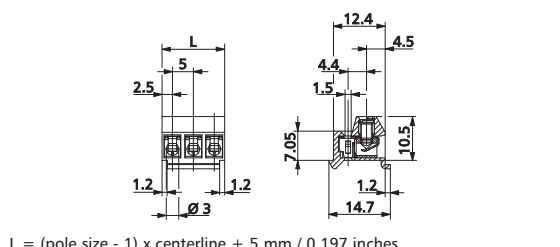

L = (pole size - 1) x centerline + 5 mm / 0.197 inches

L = (pole size - 1) x centerline + 5 mm / 0.197 inches

Part numbers (P/N)

(informations: page 60)

Complete the part number by adding the pole size.

Type 157

centerline 5 mm / 0.197 inches

P/N 311571

	02	03	04	05	06	07	08
	09	10	11	12	13	14	15
	16	17	18	19	20	21	22
	23	24					

Part numbers (P/N)

(informations: page 60)

Complete the part number by adding the pole size.

Type 137

centerline 5 mm / 0.197 inches

P/N 311371

	02	03	04	05	06	07	08
	09	10	11	12	13	14	15
	16	17	18	19	20	21	22
	23	24					

* approval pending

- Standard pole sizes
- Available on demand. Minimum order quantity 5000 pieces per item.

- Standard pole sizes
- Available on demand. Minimum order quantity 5000 pieces per item.

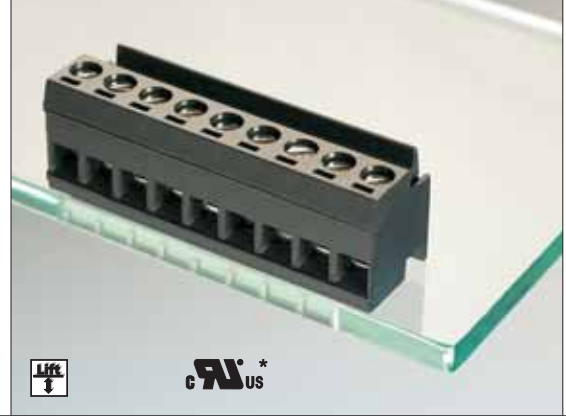
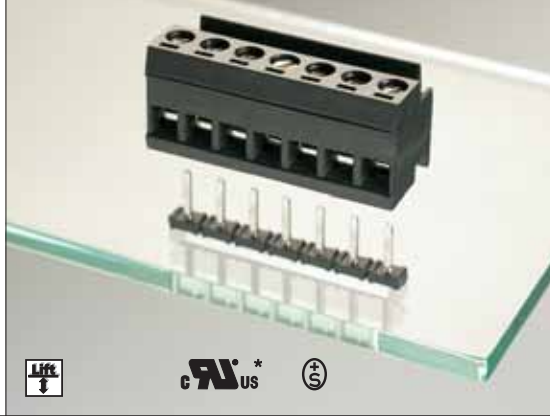

Headers

to Type 207
 Type 048 page 125

Accessories
 for Type 207 and Type 208
Coding pin
 720159 short
 720159 long page 176
Mounting flange
 750313 right
 750314 left page 174

Type 207

Screw type terminal block, pluggable, centerline 5 mm / 0.197 inches, wire entry perpendicular to plug direction, lift system, contact system with integrated wire protection

Technical Data

Ⓢ 0.08 - 2.5 mm² 250 V / 4 kV / 16 A

Insulation co-ordination according to IEC 664-1

Clearance and creepage distances	min. 3.2 mm		
Insulating material class	CTI 600		
Overvoltage category	III	III	II
Pollution degree	3	2	2
Rated voltage	250	630	630
Rated test voltage	2.5	6	4
Protection category according to IEC 529	IP20		
Tightening torque UL	4.5 lb-in max.		
Min. insul. strip length	6 mm		
Pole size	2 - 24		
Color	black		

Type 208

Screw type terminal block, pluggable, centerline 5 mm / 0.197 inches, wire entry perpendicular to plug direction, lift system, contact system with integrated wire protection, factory inserted pins

Technical Data

0.08 - 2.5 mm² 250 V / 4 kV / 15 A

Insulation co-ordination according to IEC 664-1

Clearance and creepage distances	min. 3.2 mm		
Insulating material class	CTI 600		
Overvoltage category	III	III	II
Pollution degree	3	2	2
Rated voltage	250	630	630
Rated test voltage	2.5	6	4
Protection category according to IEC 529	IP20		
Tightening torque UL	4.5 lb-in max.		
Min. insul. strip length	6 mm		
Solder pin dimension	1.0 x 1.0 mm		
Recommended pc board hole dia.	Ø 1.5 mm		
Solder pin length	3.2 mm		
Pole size	2 - 24		
Color	black		

Dimensions in mm 1 mm = 0.0394 in.

Dimensions in mm 1 mm = 0.0394 in.

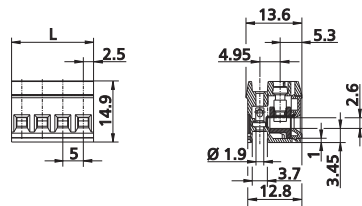

L = (pole size - 1) x centerline + 5 mm / 0.197 inches

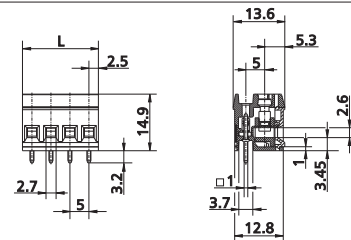

L = (pole size - 1) x centerline + 5 mm / 0.197 inches

Part numbers (P/N)

(informations: page 60)

Type 207

centerline 5 mm / 0.197 inches

P/N 312071

Complete the part number by adding the pole size.

	02	03	04	05	06	07	08
09	10	11	12	13	14	15	16
17	18	19	20	21	22	23	24

* approval pending

- Standard pole sizes
- Available on demand. Minimum order quantity 5000 pieces per item.

Part numbers (P/N)

(informations: page 60)

Type 208

centerline 5 mm / 0.197 inches

P/N 312081

Complete the part number by adding the pole size.

	02	03	04	05	06	07	08
09	10	11	12	13	14	15	16
17	18	19	20	21	22	23	24

* approval pending

- Standard pole sizes
- Available on demand. Minimum order quantity 5000 pieces per item.