





## Terminal blocks

to 710084 and 710085

-  Type 007 page 91
-  Type 107 page 92
-  Type 108 page 92

## 710084 and 710085

The latching flanges are attached to the side of the terminal block and secured to the printed circuit board with a quarter turn of the screw.

Dimensions in mm 1 mm = 0.0394 in.

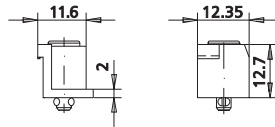

### Drill pattern for pc board

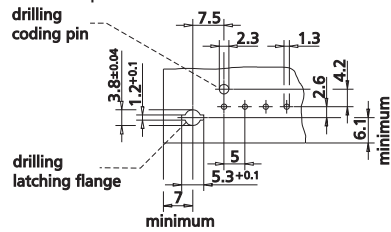

## Part numbers (P/N)

### Mounting flanges

- right P/N 710084
- left P/N 710085

Left or right flange required per terminal block.



## Terminal blocks

to 750150 and 750151

 **Type 077** page 91

 **Type 079** page 99

to 750313 and 750314

 **Type 137** page 93

 **Type 207** page 94

 **Type 208** page 94

## 750150 and 750151

The mounting flanges are attached to the side of the terminal block and secured to the printed circuit board by tightening the screw.

## 750313 and 750314

The mounting flanges are attached to the side of the terminal block and secured to the printed circuit board by tightening the screw.

Dimensions in mm

1 mm = 0.0394 in.

Dimensions in mm

1 mm = 0.0394 in.

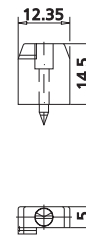

Drill pattern for pc board

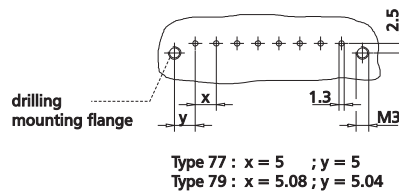

Drill pattern for pc board

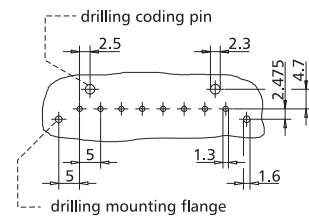

## Part numbers (P/N)

### Mounting flange

right P/N 750150  
left P/N 750151

Left or right flange required per terminal block.

## Part numbers (P/N)

### Mounting flange

right P/N 750313  
left P/N 750314

Left or right flange required per terminal block.



## Terminal blocks

to 720158

 Type 166 page 87

to 720036

 ASP025 page 51

## 720158

The mounting flange is inserted into the groove in the side of the terminal block and secured to the printed circuit board by being press fit into the hole in the printed circuit board.

## 720036

The mounting flange is inserted into the mounting hole in the side of the terminal block and secured to the printed circuit board by being press fit into the hole in the printed circuit board.

Dimensions in mm

1 mm = 0.0394 in.

Dimensions in mm

1 mm = 0.0394 in.

720158-01-2

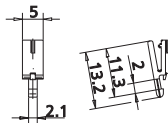

720158-02-2

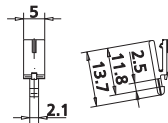

720036-01-4



720036-02-2

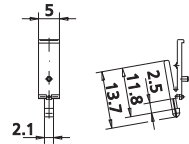

Drill pattern for pc board

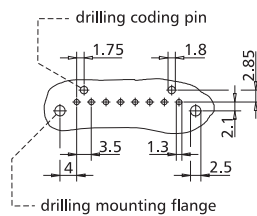

Drill pattern for pc board

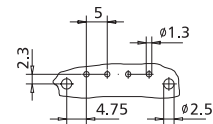

## Part numbers (P/N)

### Mounting flange

for pc board 1 mm / 0.039 in. P/N 720158-01-2  
for pc board 1.5 mm / 0.039 in. P/N 720158-02-2

Two flanges are required per terminal block.

## Part numbers (P/N)

### Mounting flange

for pc board 1 mm / 0.039 in. P/N 720036-01-4  
for pc board 1.5 mm / 0.039 in. P/N 720036-02-2

Two flanges are required per terminal block.