

Headers

to **Type 249** and **Type 250**

- Type 178** page 144
- Type 179** page 140
- Type 219** page 139
- Type 220** page 140
- Type 229** page 143
- Type 230** page 144
- Type 286** page 142
- Type 288** page 146
- Type 290** page 142
- Type 292** page 146

Accessories
for **Type 249**

(only in combination with headers type 178, 179, 219, 220, 229 and 230)
coding set
700025 page 180

Type 249

Screw type terminal block, pluggable, centerline 5.08 mm / 0.200 inches, wire entry parallel to plug direction, lift system, contact system with integrated wire protection

Technical Data

	V / A / AWG	300 / 16 / 28 - 12
	V / A / AWG	300 / 16 / 28 - 12
	0.08 - 2.5 mm ²	250 V / 4 kV / 16 A
Insulation co-ordination according to IEC 664-1		
Clearance and creepage distances	min. 3.6 mm	
Insulating material class	CTI 600	
Overvoltage category	III	III II
Pollution degree	3	2 2
Rated voltage	250	630 630
Rated test voltage	2.5	6 4
Protection category according to IEC 529		
	IP20	
Tightening torque UL	4.5 lb-in max.	
Min. insul. strip length	8 mm	
Pole size	2 - 24	
Color	black	

Type 250

Screw type terminal block, pluggable, centerline 5.08 mm / 0.200 inches, wire entry parallel to plug direction, lift system, contact system with integrated wire protection, strain relief

Technical Data

	V / A / AWG	300 / 16 / 28 - 12
	0.08 - 2.5 mm ²	250 V / 4 kV / 16 A
Insulation co-ordination according to IEC 664-1		
Clearance and creepage distances	min. 3.6 mm	
Insulating material class	CTI 600	
Overvoltage category	III	III II
Pollution degree	3	2 2
Rated voltage	250	630 630
Rated test voltage	2.5	6 4
Protection category according to IEC 529		
	IP20	
Tightening torque UL	4.5 lb-in max.	
Min. insul. strip length	8 mm	
Pole size	3 - 12	
Color	black	

Dimensions in mm 1 mm = 0.0394 in.

Dimensions in mm 1 mm = 0.0394 in.

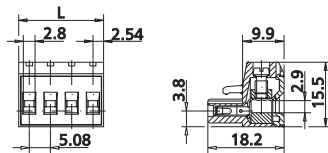

$L = (\text{pole size} - 1) \times \text{centerline} + 5.08 \text{ mm} / 0.200 \text{ inches}$

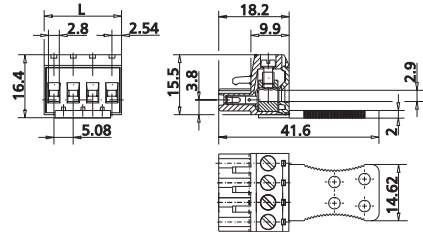

$L = (\text{pole size} - 1) \times \text{centerline} + 5.08 \text{ mm} / 0.200 \text{ inches}$

Part numbers (P/N)

(informations: page 60)

Type 249

centerline 5.08 mm / 0.200 inches

P/N 312491

Complete the part number by adding the pole size.

	02	03	04	05	06	07	08
09	10	11	12	13	14	15	16
17	18	19	20	21	22	23	24

Type 249

centerline 10.16 mm / 0.400 inches

P/N 312492

	02	03	04	05	06	07	08
09	10	11	12				

Standard pole sizes

Available on demand. Minimum order quantity 5000 pieces per item.

Part numbers (P/N)

(informations: page 60)

Type 250

centerline 5.08 mm / 0.200 inches

P/N 312501

Complete the part number by adding the pole size.

		03	04	05	06	07	08
09	10	11	12				

Standard pole sizes

Available on demand. Minimum order quantity 5000 pieces per item.

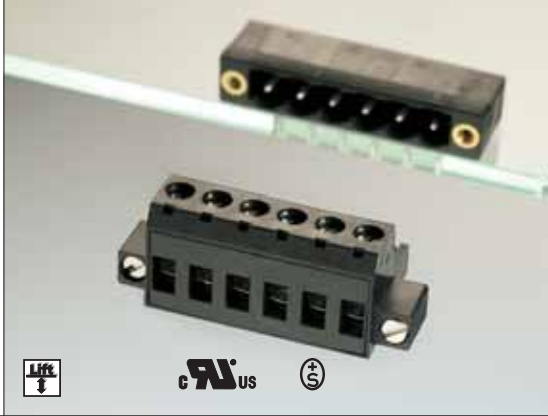

Headers

to Type 251

Type 235 page 141

Type 236 page 145

Accessories

for Type 251

coding set

700025 page 180

Type 251

Screw type terminal block, pluggable, centerline 5.08 mm / 0.200 inches, wire entry parallel to plug direction, lift system, contact system with integrated wire protection, with mounting flange

Technical Data

V / A / AWG 300 / 16 / 28 - 12

0.08 - 2.5 mm² 250 V / 4 kV / 12 A

Insulation co-ordination according to IEC 664-1

Clearance and creepage distances min. 3.6 mm

Insulating material class CTI 600

Overvoltage category III III II

Pollution degree 3 2 2

Rated voltage 250 630 630

Rated test voltage 2.5 6 4

Protection category according to IEC 529 IP20

Tightening torque UL 4.5 lb-in max.

Min. insul. strip length 8 mm

Pole size 2 - 24

Color black

Dimensions in mm

1 mm = 0.0394 in.

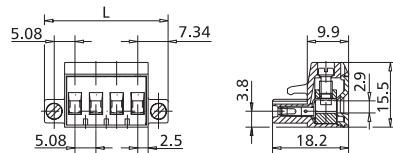

L = (pole size - 1) x centerline + 14.68 mm / 0.578 inches

Part numbers (P/N)

(informations: page 60)

Complete the part number by adding the pole size.

Type 251

centerline 5.08 mm / 0.200 inches

P/N 312511

	02	03	04	05	06	07	08
09	10	11	12	13	14	15	16
17	18	19	20	21	22	23	24

Type 251

centerline 10.16 mm / 0.400 inches

P/N 312512

	02	03	04	05	06	07	08
09	10	11	12				

Standard pole sizes

Available on demand. Minimum order quantity 5000 pieces per item.