

KLDX Series PCB Mount Mini DC Power Jack

Features



- 1.0mm and 1.3mm
- Built in DC On/Off Switch
- Screw Machine Contact Center Pin for High Current Capability
- CSA/NRTL Certified File No. LR78160

Performance Specifications

Materials and Finish



Standard : Plastic Housing: UL 94V-0 Rated, Black Color

Center Pin : Copper Alloy, Nickel Plated

Contact #1 and #3 : Brass, Tin Plated

Contact #2 : Phosphor Bronze, Tin Plated

HT Option:

Plastic Housing : High Temperature Thermoplastic, UL 94V-0 Rated, Black Color

Center Pin : Copper Alloy, Nickel Plated

Contact #1 and #3 : Brass, Silver Plated

Contact #2 : Phosphor Bronze, Silver Plated

Electrical Characteristics

Contact Resistance

Before Durability Test

Between Terminals : 30 Milliohms Max.

Plug to Contacts : 50 Milliohms Max.

After Durability Test

Between Terminals : 60 Milliohms Max.

Plug to Contacts : 100 Milliohms Max.

Rated Voltage : DC 24V, Rated Current: 2.5 Amps

Insulation Resistance : 100 Megohms Min.

Mechanical Characteristics

Durability Test : 5000 Cycles

Insertion Force : 0.3kg - 2.0kg

Extraction Force : 0.3kg - 2.0kg

Operating Temperature : -25°C to +85°C

DC POWER CONNECTORS

KLDX Series

Documentation & Ordering Information

Kycon Part

Part Number Builder

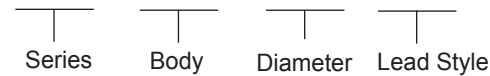

Series

KLDX- PCB Mount Mini DC Power Jack

Body

0101 - Open

0201 - Closed

Diameter

A - 1.0mm Inner Pin Diameter

B - 1.3mm Inner Pin Diameter

Lead Style

Blank - Standard Straight

C - Crimped (Available only with KLDX-0201)

Contact Kycon for Hi Temp and TR option

KLDX Series Dimensions

Dimensions in mm

KLDX-0201-A, KLDX-0201-B

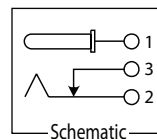
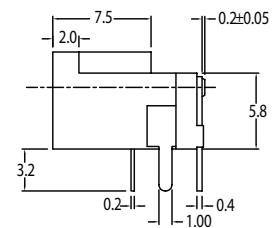
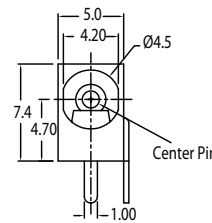

Available with Crimped Leads
Please Contact Factory for PCB Layout
(-AC & -BC Options)

KLDX-0201-AHT, KLDX-0201-BHT

