

Series 32500

.325", 8.25mm Center-to-Center Spacing

Current Rating: CSA & UL :15 amps
(20 Amps with 12AWG & Lugs)

Voltage Rating: UL & CSA – 300 volts

Breakdown Voltage:

Terminal - Terminal 3,600 Typ.

Terminal - Ground 4,700 Typ.

 **Recognized under the Components Program of Underwriters Laboratories, Inc. Standard 1059, Guide No. XCFR2, File No. E62557.**

 **Guide No. 22.2 No. 158, Report No. LR39186-1.**

No. of Terminals: 1 through 26
(1 through 28 without mounting holes)

Wire Range: UL recognized for No. 22AWG to No. 14AWG.

Tightening Torque: 9 in.-lbs.

Barrier-Type Construction – Blocks are made of break-resistant thermoplastic molding with integrally mounted .172" diameter mounting holes.

Terminal Flexibility – External terminals available in two No. 6-32 screw designs. Internal terminals include an .032" diameter printed circuit pin, and turret-type solder pins.

Housing:

Material	Polypropylene
Continuous Use Temp. (UL Index)	105° C (221° F)
Flammability Rating	UL 94V-0



Features:

- **Complete Line of .325" Offset Blocks** – Including base mount, P.C. Pin, wire wrap, turret, and right angle terminals.
- **Open or Tri Barrier Designs** – To meet your wiring requirements.
- **Molded in Standoffs** – To aid in the board cleaning process.
- **A Multitude of Screw and Wire Terminals Available** – Including wire clamps, wire ready screws, and combo head screws.

Mechanical Drawing

32500 Surface Mount
With or Without Mounting Ends

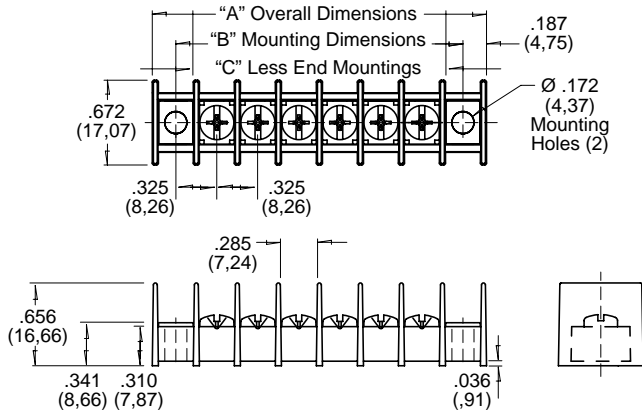

32500 Tri-Barrier Surface Mount
With or Without Mounting Ends

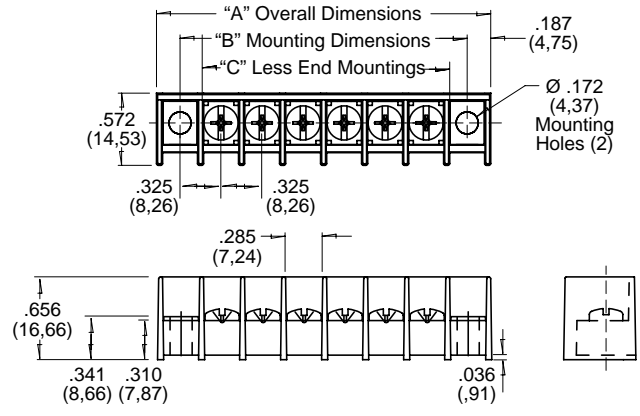

Dimensions shown are ± 0.030"

Number of Terminals	Series 32500 With Mounting Ends				Without Mounting Ends	
	Dimensions					
	B ± .031 Mounting Dimensions (M.D.)		A ± .031 Overall Dimensions (O.D.)		C ± .031 Less Mounting Ends	
	Inches	Metric (mm)	Inches	Metric (mm)	Inches	Metric (mm)
1	.650	16.51	1.023	25.98	.373	9.47
2	.975	24.77	1.348	34.24	.698	17.73
3	1.300	33.02	1.673	42.49	1.023	25.98
4	1.625	41.30	1.998	50.75	1.348	34.24
5	1.950	49.53	2.323	59.00	1.673	42.49
6	2.275	57.79	2.648	67.26	1.998	50.75
7	2.600	66.04	2.973	75.51	2.323	59.00
8	2.925	74.30	3.298	83.77	2.648	67.25
9	3.250	82.55	3.623	92.02	2.973	75.51
10	3.575	90.81	3.948	100.28	3.298	83.77
11	3.900	99.06	4.273	108.53	3.623	92.02
12	4.225	107.32	4.598	116.79	3.948	100.28
13	4.550	115.57	4.923	125.04	4.273	108.53
14	4.875	123.83	5.248	133.30	4.598	116.79

Number of Terminals	Series 32500 With Mounting Ends				Without Mounting Ends	
	Dimensions					
	B ± .031 Mounting Dimensions (M.D.)		A ± .031 Overall Dimensions (O.D.)		C ± .031 Less Mounting Ends	
	Inches	Metric (mm)	Inches	Metric (mm)	Inches	Metric (mm)
15	5.200	132.08	5.573	141.55	4.923	125.04
16	5.525	140.34	5.898	149.81	5.248	133.30
17	5.850	148.59	6.223	158.06	5.573	141.55
18	6.175	156.85	6.548	166.32	5.898	149.81
19	6.500	165.1	6.873	174.57	6.223	158.06
20	6.825	173.36	7.198	182.83	6.548	166.32
21	7.150	181.61	7.523	191.08	6.873	174.57
22	7.475	189.87	7.848	199.34	7.198	182.83
23	7.800	198.12	8.173	207.59	7.523	191.08
24	8.125	206.38	8.498	215.85	7.848	199.34
25	8.450	214.63	8.823	224.10	8.173	207.60
26	8.775	222.89	9.148	232.36	8.498	215.85
27					8.823	224.10
28					9.148	232.36

Dimensions shown are ± 0.030"

Part Number

How to Order

325 X X X XX X

MOLDING DESIGN

- 0 = Open Back w/ Mounting Ends
- 1 = Open Back w/o Mounting Ends
- 2 = Tri Barrier w/ Mounting Ends
- 3 = Tri Barrier w/o Mounting Ends

INSERT OR BOTTOM TERMINATION DESIGN

- 0 = Base Mount Insert
- 1 = Printed Circuit Pin
- 2 = Wire Wrap Pin
- 3 = Turret Type Pin
- 4 = Right Angle Printed Circuit Pin

SPECIALS OR OPTIONAL DESIGNS

- 0 = None
- A-Z = Custom Configuration

NUMBER OF POSITIONS
01 through 26,

HARDWARE OR TOP TERMINATION DESIGN

- 0 = 6-32 Steel Combo Head Screw
- 1 = 6-32 Wire Clamp Head Screw
- 2 = 6-32 Brass Combo
- 3 = 6-32 Stainless Steel Screw
- 5 = Supplied w/o Screws
- 8 = 6-32 Captivated Steel Combo Head
- 9 = 6-32 Captivated Wire Clamp

Specifications

Series 32500 Open Back

0 – Flush Mount

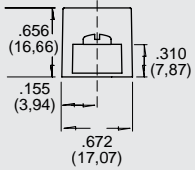

1 – PC Pin

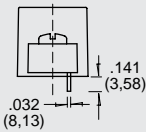

2 – Wire Wrap

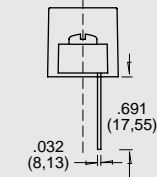

3 – Turret Type

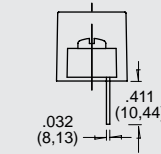

4 – Right Angle PC Pin

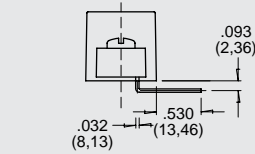

Series 32500 Tri-Barrier

0 – Flush Mount

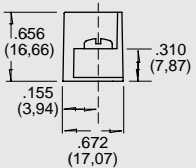

1 – PC Pin

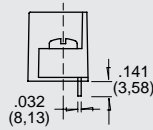

2 – Wire Wrap

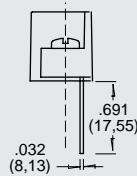

3 – Turret Type

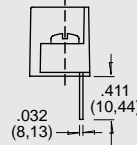

4 – Right Angle PC Pin

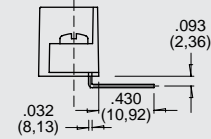

Dimensions shown are ± 0.030"

PC BOARD DRILLING DIMENSIONS

